



Continuous Evolution

Cube<sup>+</sup>

Cube<sup>+</sup>  
kangensui

change your day  
with Cube+



STYLISH LIFE DEVICE Kangensui Cube+

# With "+" (Positive) Intentions, Every Day is a Brand New Day!



Your life **plus** Cube+ ...

**Healthy, Stylish, Economical, and Ecological** lifestyle.

For you and your loving family,

Cube+ supports a vibrant lifestyle with home water.

SANWA's evolutionary product.

Home water purification and processing instrument

Kangensui "**Cube+**"

Approval of the Japanese Ministry of Health, Labour and Welfare :  
a home-use medical equipment.

Effects and Efficacies : Improve gastrointestinal symptoms

- Relieves stomach discomfort and indigestion.
- Helps digestion and regulates bowel movement.

Manufacture and Sale of Medical Equipment approval number : 221AGBXZ00290A01  
This instrument is manufactured as a medical device accordingly  
to the Pharmaceutical Affairs Law of Japan, in Section 4, Article 2, paragraph 6,  
and approved by the Minister of Health Labour and Welfare as a medical equipment.

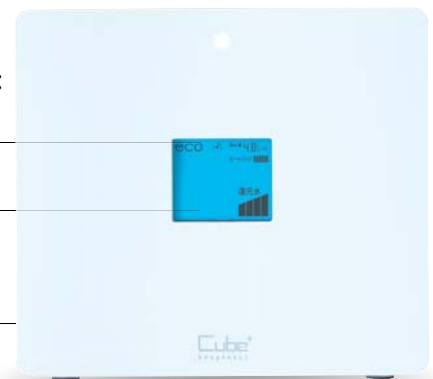



## Health

Effective in improving gastrointestinal symptoms.  
Relieving stomach discomfort and indigestion.  
Helps digestion and bowel movement regulation.  
Cube+ provides  
safe, secure, and healthy water at your home.



## Eco

Hydrogen-rich Antioxidant Water  
is for drinking and cooking,  
and simultaneously generated Electrolyzed Acidic Water  
is for face washing and house cleaning;  
Ecological uses of the water resource.  
With a built-in latest technology of reduced power consumption  
helps power-saving measures of your household.  
Also, Cube+ itself is economically priced.



## Stylish

The stylish body of Cube+ colors your kitchen.  
Simple and compact design in all angles.  
A friendly addition to your stylish life.



## Plus

Enhanced durability from the previous lineup,  
while keeping its easy usability.  
For you to always use a quality water every day,  
Cube+ has evolved.

# Simple and Compact combined in a high-dimensional design

## Various features inside the ultimate form of Kangensui



### Conceptual diagram

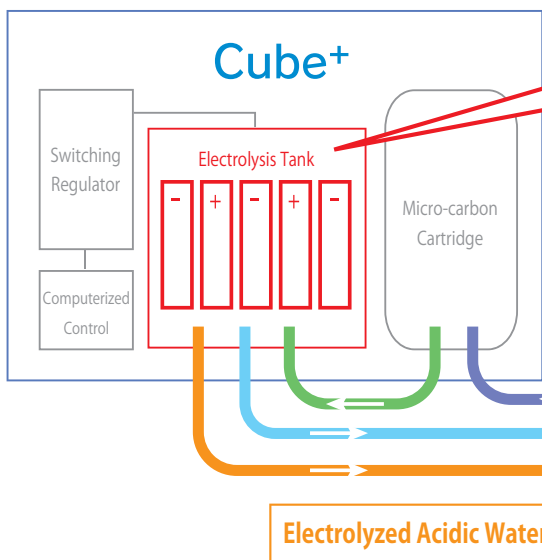

### Cube+ Platinum-plated Electrodes

**Extended the product life cycle up to 3,000 hours**

1,400 hours → 3,000 hours

the former product → [Cube+]

※The pictures shown are only the concept image.

Our development of a refined platinum-plated electrode has enhanced the product lifecycle.

### Double Auto-Change Cross-Line System sustains a generation of the quality Antioxidant Water

The chemical reaction of electrolysis deposits minerals such as magnesium and calcium in water, and they accumulate around plates of the negative electrode. As a result of minerals covering up the electrodes makes electrolysis of water difficult.



### WACC system sustainably keeps the electrode plates clean.

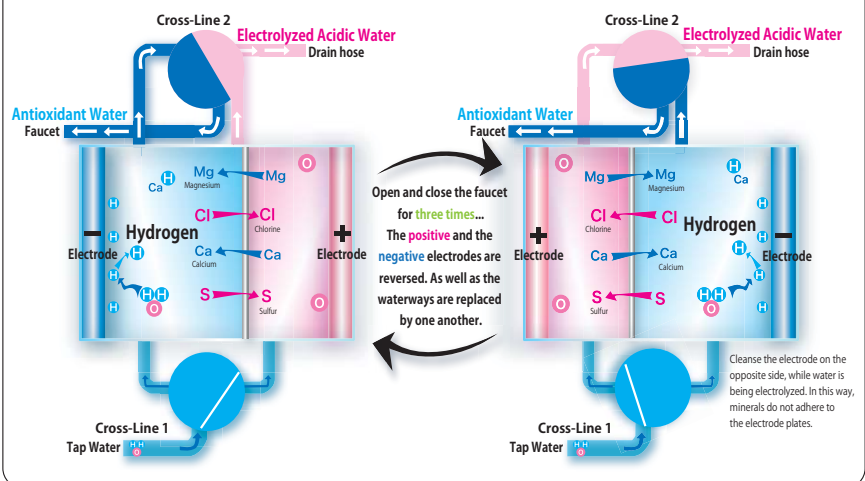

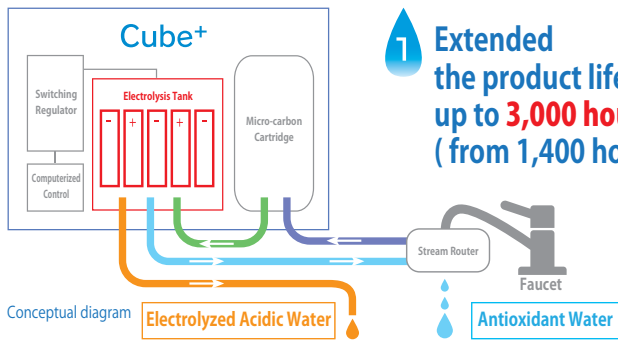

**1** Extended the product lifecycle up to **3,000 hours!** (from 1,400 hours)

**6** Switching Regulator Control System corresponds to quality changes of intake water.

The quality of tap water changes, depending on a region, season, or temperature, and the Switching Regulator Control System automatically corresponds to those changes to produce a quality Antioxidant Water for all time. This feature is also an eco-technology of Cube+ that works to save power.

**2** The Hydrogen LED flashes, when hydrogen is being generated in the water.

When processing Antioxidant Water, the Hydrogen LED flashes to indicate that hydrogen is being generated in the water. It blinks faster when the concentration of hydrogen in the water is higher, and blinks slower when it is low.



**7** Multi-Layered High Efficiency Electrolysis Tank with 5 platinum-plated electrodes.

With a four-layered eight-cell electrolysis tank, Cube+ efficiently uses power for electrolysis.

**8** Premium Micro-Carbon Cartridge

Filtering 7 tons of 13 substances \*, specified for removal by the Japanese Industrial Standard, in common tap water.

The Micro-Carbon Cartridge is made of a fine-grained active carbon, which effectively absorbs turbidities and particles found in common tap water. With our innovative method, it filters 13 substances\*, specified for removal by the Japanese Industrial Standard, in common tap water. In addition, the filtration material of the cartridge is created to prevent clogging; therefore, it would not interfere a flow of water.

\* specified substances for removal by the JIS S3201 testing method.

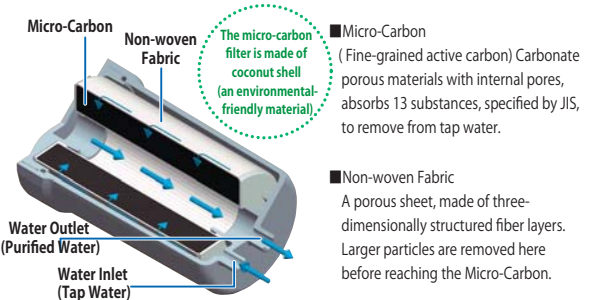

**3** The LCD screen clearly displays status of Cube+ in colors.



The LCD screen color turns blue with Antioxidant Water, turns orange with Electrolyzed Acidic Water, and turns green with the Purified Water, when they are each being generated. Also a melody plays with Antioxidant Water.

**4** The Drain Volume Adjustment Knob is for saving water.



The Drain Volume Adjustment Knob controls the balance between a volume of Antioxidant Water and the drainage water, processed in Cube+. The concentration of Antioxidant Water can also be adjusted with the Drain Volume Adjustment Knob. (The default intake and drainage water ratio = 5:1)

**5** "eco" button to save the power consumption. Cube+ is an eco-friendly water instrument.

Just as easy as pressing the "eco" button, Cube+ operates in the power conservation mode, which cuts off 70% of the power used for the electrolysis, and cuts off 50% of the total power consumption of the instrument (compared to existing products). Also, it only spends 0.5 Watts in the standby mode. This function is effective for hard water origins where the processed Antioxidant Water's pH value tends to be too high.



Substances that can be removed (Total filtration quantity : 7 tons)	
1. Chlorine Residual (Chalk)	7. Bromoform
2. Turbidity	8. Tetrachlorethylene
3. General Trihalomethane *2	9. Trichlorethylene
4. Chloroform	10. 1. 1. 1 - Trichloroethane
5. Bromodichloromethane	11. CAT (Pesticides)
6. Dibromochloromethane	12. 2-MIB (Mold Odor)
	13. Solubility of Lead

\*2 General Trihalomethane is a term for the four substances, listed as 4 to 7 above.

**What are the JIS specified 13 substances?**

1 Chlorine Residual (Chalk)	A substance added in tap water for sterilization, yet creating a bad taste.
2 Turbidity	Representing turbidity of water in general. Red rust is included.
3 General Trihalomethane	Common constituents of General Trihalomethane are 4 Chloroform, 5 Bromodichloromethane, 6 Dibromochloromethane, and 7 Bromoform. These are products of the chemical reaction of organic compounds in raw water and Chlorine, added for sterilization of a water supply. They are possibly carcinogenic.
8 Tetrachlorethylene	Can be a cause of liver and kidney failure, and is possibly carcinogenic. Used as an industrial stain remover.
9 Trichlorethylene	Can be a cause of liver and kidney failure, and is possibly carcinogenic. Used as a dry-cleaning solvent and a metal degreaser.
10 1. 1. 1 - Trichloroethane	Can be a cause of liver and kidney failure, and is possibly carcinogenic. Used as an industrial metal degreaser.
11 CAT (Pesticides)	Suspected to have endocrine disrupting effects. Commonly used in herbicides.
12 2-MIB (Mold Odor)	An unpleasant smell also causes a bad taste.
13 Solubility of Lead	An accumulated solubility of lead in the body can be a risk of causing intellectual disabilities of infants and fetuses.

※ A Micro-Carbon Cartridge needs to be replaced every year or every 7 tons of the accumulated water flow.

**Water consists a full of Hydrogen.**

**Antioxidant Water is produced from Electrolysis of water.**

In chemical formula, a water molecule "H<sub>2</sub>O" consists of two hydrogen atoms and an oxygen atom, and normally they are inseparable while being water.

The energy of electrolysis is equivalent to an energy of heating water up to 12,000 degrees. Because of utilizing this much of energy, hydrogen and oxygen atoms can be disconnected from one another. The hydrogen atoms disconnected from oxygen, are called Active Hydrogen.

There are many water purifiers nowadays, but SANWA's products are exceptional.

Kangensui Cube+ is a home water purification and processing instrument, as well as a medical equipment, certified by the Ministry of Health, Labour and Welfare.

The instrument is manufactured as a medical device according to the Pharmaceutical Affairs Law of Japan, in Section 4, Article 2, Paragraph 6, and certified by the Ministry of Health, Labour and Welfare as a medical equipment.

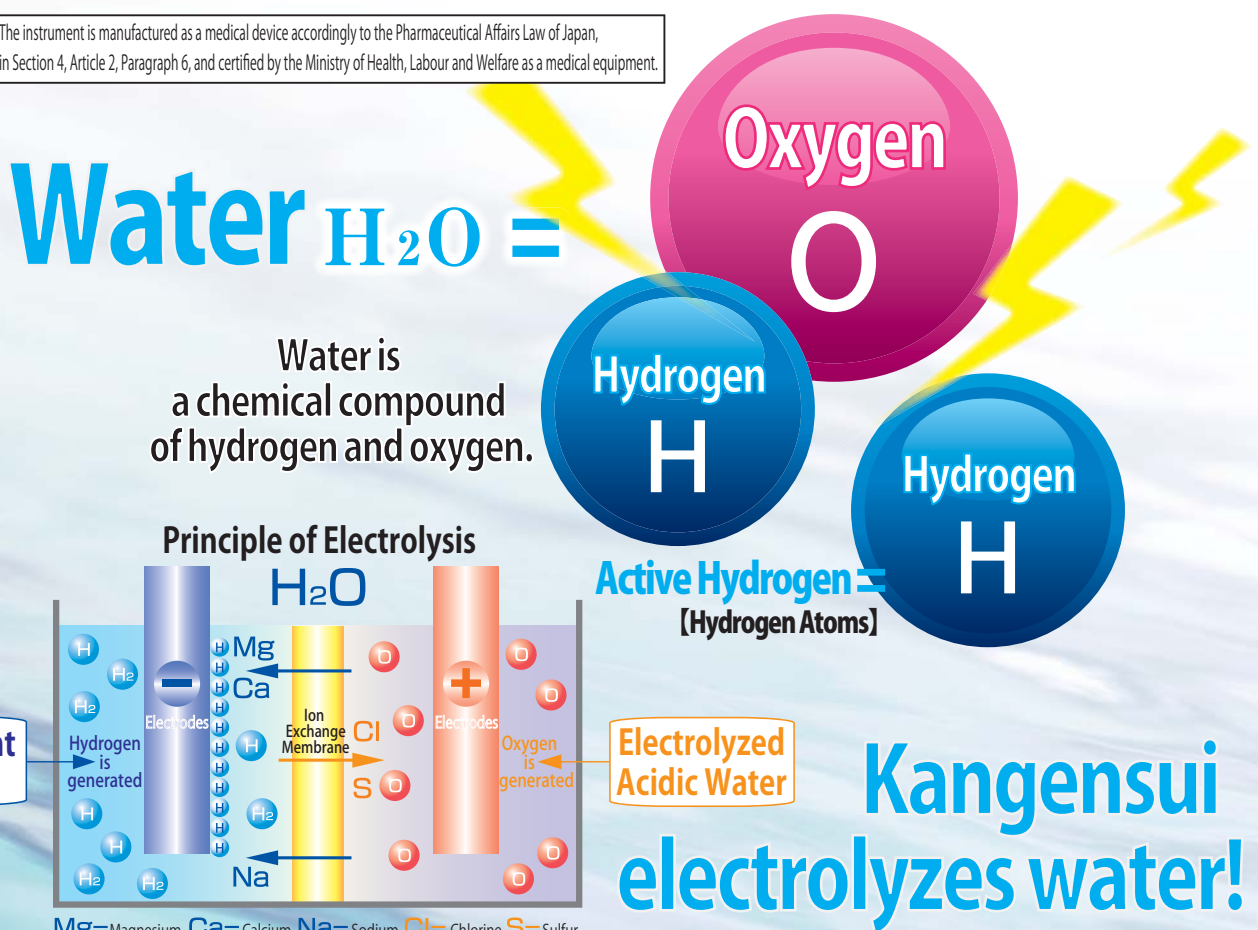

The hydrogen-rich water is called "Antioxidant Water," and the oxygen-rich water is called "Electrolyzed Acidic Water."

Kangensui Cube+ is capable of producing those two types of water from a home tap water.

Relationship between **Oxidation** and **Reduction (Deoxidation)**

**Oxidation**

Compounding with oxygen, losing hydrogen, and losing electrons. An Apple gets brown and Iron rusts through the process of oxidation.

**Reduction (Deoxidation)**

Compounding with hydrogen, losing oxygen, and gaining electrons. This reaction prevents iron from rusting.

## Antioxidant Water enriches your dietary life.

Antioxidant Water is hydrogen-rich alkaline water, generated by electrolysis, in the negative side of the electrodes. It is drinkable as is, and also can be used for cooking.

Because it is effective for regulating a bowel movement and relieving stomach discomfort, especially recommended for people who suffer from constipation.



As well as drinking it directly, it brings out a taste of coffee and tea.



For simmered dishes like stews, it brings out the taste and flavor of the ingredients.



With Antioxidant Water, clear elegant tasty soup stock can be made.



It can be used to remove harshness from vegetables.



With Antioxidant Water, rice is cooked to be soft and delicious.

## Electrolyzed Acidic Water supports your house cleaning and skin care.

Electrolyzed Acidic Water is oxygen-rich acidic water, generated by electrolysis, in the positive side of the electrodes. It can be used for face washing, hair washing, and skin care, as well as for house cleaning and hygienic purposes.



It can be used directly for face washing, and it also can be used with a steamed towel or a cotton ball for daily skin care.



Because it helps remove stains and dries fast, it is recommended for wiping as well as soak-washing of kitchenware.



Using it with the batter, tempura is cooked crispy and juicy.

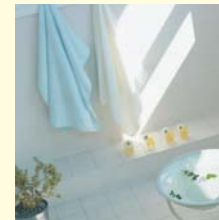

It can be used for a wide range of hygienic purposes like dishwashing, house cleaning.

## Purified Water is also available with Cube+.



The Purified Water is unelectrolyzed water, which the JIS specified harmful substances are filtered.

It is suitable for taking medicines and making baby formula with.

# Kangensui Cube+ purifies and processes tap water with a simple installation on a home faucet.



## ■ The types of faucet, APPLICABLE for a standard installation.

The faucet Stream Router can be installed with one of the standard mounting adapters.



## ■ The types of faucet, INAPPLICABLE for a standard installation.

An additional work is required for an installation of the faucet Stream Router.

▼ shower head type



▼ square, slim, or peculiar shaped type



▼ built-in type



## Standard installations of the Faucet Stream Router

### A type

- Faucet pipe diameter (16mm, 17.5mm, 19mm)
- Use type A mounting adapter for the faucet with a swollen round shape on its tip.



### B type

- By detaching the faucet aerator, screw grooves can be seen on the outer surface of the pipe.
- Use type B mounting adapter for this kind of faucet.



### C type

- By detaching the faucet aerator, screw grooves can be seen on the inner surface of the pipe.
- Use type C mounting adapter for this kind of faucet.

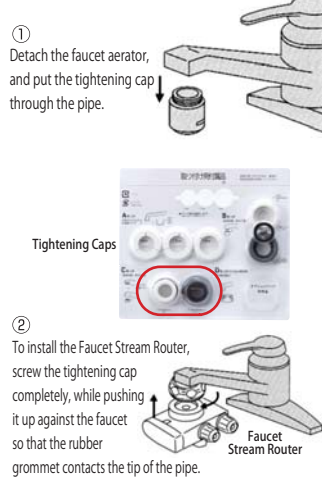

### D type

- The faucet that has a round-shaped tip.
- Use type D mounting adapter for a faucet of round shaped pipe without a swollen tip.

Type D mounting adapter is not included in the standard mounting adapter kit, please ask your sales representative for purchase.

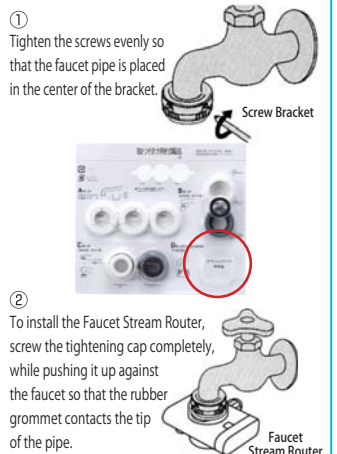











# Kangensui Cube+ can be installed on various faucets with designed custom parts.

## Examples of Custom Installation









For the types of faucet shown below, the designed custom parts are available for installation.

### Installation examples of the isolated Facet Stream Router 1

 Before installation	+	 Circumfluence Cock [Cube+ customized] (RWC007)	=	
 1-Way Faucet Stream Router plug	+	 Flexible Return Valve [Cube+ customized] (RWC008)	=	
	+	 Rigid Return Valve [Cube+ customized] (RWC009)	=	

This type of installation is available for uncommon faucets, on which a standard installation of the Facet Stream Router cannot be applied. It is also available when remodeling of the kitchen is impossible. The information of an existing faucet is required to determine the necessary custom parts for installation.

### Installation examples of the independent Facet Stream Router 2

 Before installation	+	 Circumfluence Cock [Cube+ customized] (RWC007)	=	
 1-Way Faucet Stream Router plug (NSJ-S268A7)	+	 Flexible Return Valve [Cube+ customized] (RWC008)	=	
	+	 Rigid Return Valve [Cube+ customized] (RWC009)	=	

This type of installation is available for a wall-mounted kitchen faucet, on which a standard installation of the Facet Stream Router cannot be applied.

## Installation example of the Faucet Stream Router on a detachable faucet pipe

A type of faucet, capable of detaching the pipe from its base.

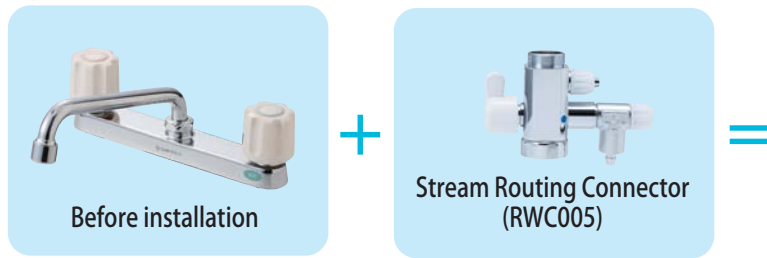

This type of installation is to improve usability of Kangensui Cube+.

## Installation examples of the designed faucet

This type of installation is available for a faucet, on which a standard installation of the Faucet Stream Router cannot be applied. It is also available for customer requesting a better usability and neat hose-connections on the kitchen counter.

The cost of this type of installation may vary depending on the installation location and circumstances.

For other types of the designed faucet, please ask your sales rep.

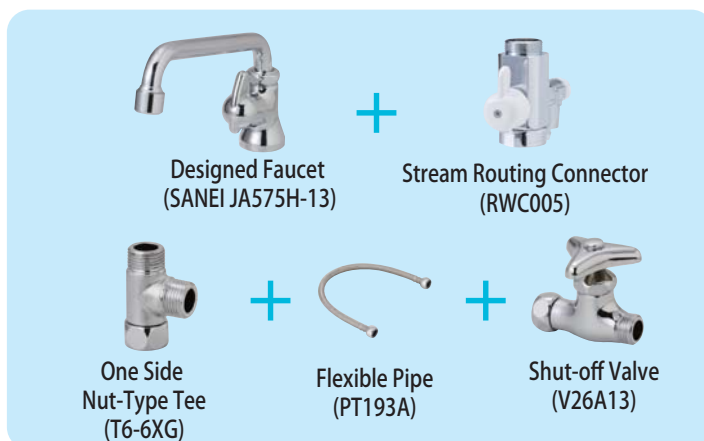
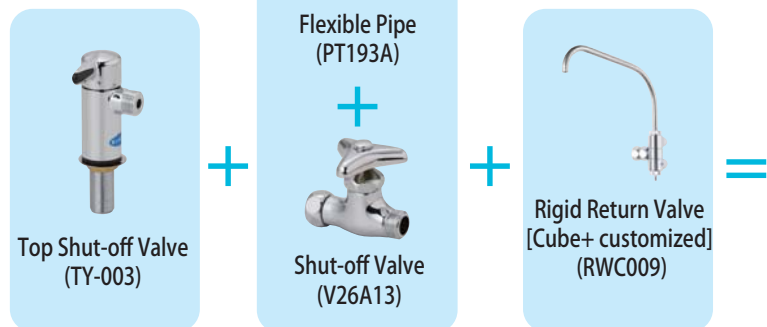
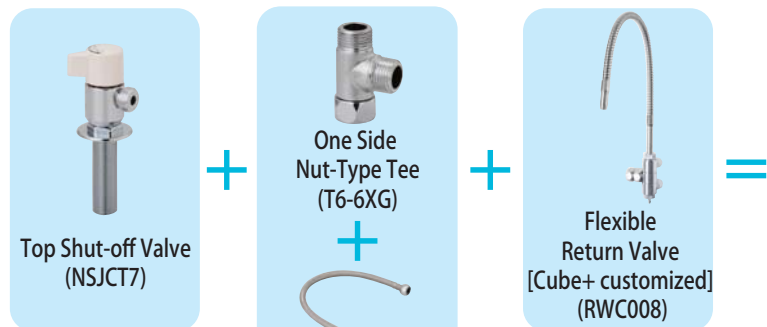
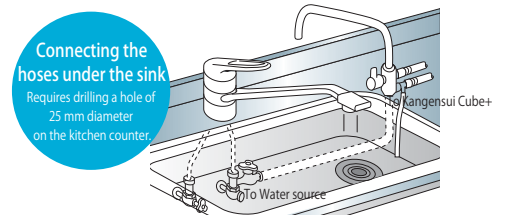

## Installation examples of the Faucet Stream Router on an extraordinary faucet

This type of installation is available for the customized faucet, its water stream is currently routed for dishwasher.

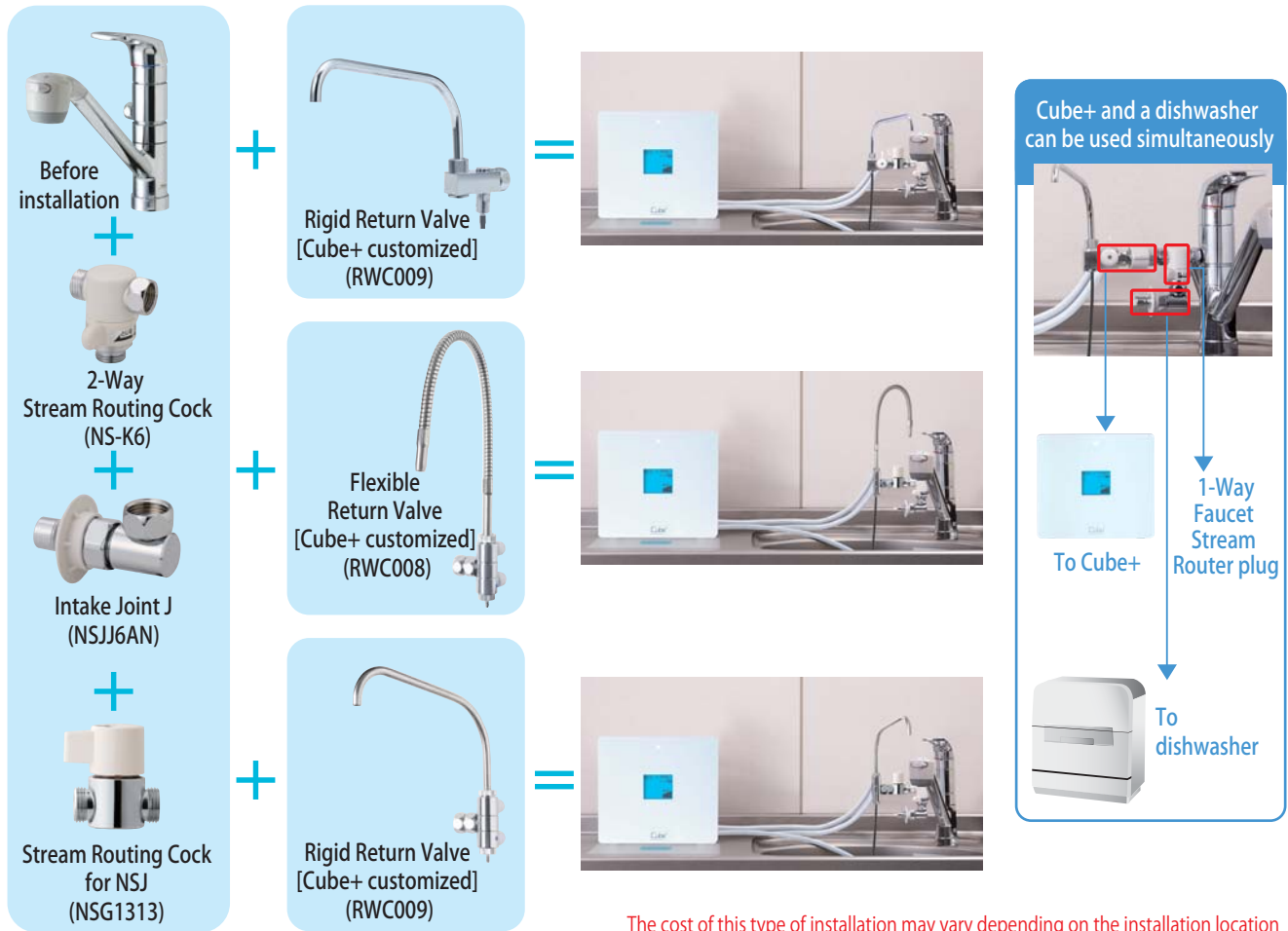

The cost of this type of installation may vary depending on the installation location and circumstances. For other types of the designed faucet, please ask your sales rep.

## Supply & Option

consumable supplies and optional item lineups



Cartridge for Cube+ [Micro-Carbon] (RWC001)



Primary Filter Case and Filter replacement set for Cube+ (RWC020)

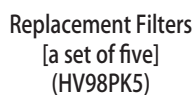

Replacement Filters [a set of five] (HV98PK5)



Faucet Stream Router set for Cube+ (RWC002)



Standard Faucet Stream Router (RWC003)



Standard Adapter set (RW004)



Image



Wall-mounting Hanger set (RWCNUR)



Image



Body Cover for Cube+



Twin hose for Cube+ [1m] (RWC013A)



Single hose for Cube+ [1m] (RWC012A)



Hose set for Cube+ [1m] (RWC011)



Hose Fixing Sucker (RW016)

Continuous Evolution

# Cube<sup>+</sup>



## ■ Replacement of Cartridge

### Cube+ Cartridge

The total filtration capacity of Cube+'s cartridge (Micro-Carbon) is 7 tons. It generally lasts one year with home use.

Please make sure to replace the cartridge, when needed, for Cube+ to work in its full capacity.

※The replacement period of a cartridge may vary depending on Cube+'s used region or tap water quality.

## 3-year warranty

For you to comfortably use kangensai Cube+, we have extended the product warranty to three years from originally one year.

For detail information about the warranty, please read the 3-year warranty certification, included in the product package.

## ! Notice

In case of collecting the drain water, please make sure to close the faucet completely, every time after usage.

**[Note]** If the faucet is not closed completely, water continuously flows out of the drain hose, which may cause flooding of a water collection tank.

**[Precedent]** The faucet had not been closed completely before going to sleep at night, and it caused flooding of the water collection tank on a kitchen floor. The drain water leaked to the downstairs-resident of the mansion, the customer lived in.

Please make sure to close the faucet every time after a usage.

## Caution

- Do not drink Antioxidant Water, if you have a kidney disorder such as renal failure and potassium excretion impediment.
- If you have a liver or kidney discomfort, please consult with your doctor before drinking Antioxidant Water.

## Cube<sup>+</sup> [RW-Cube<sup>+</sup>]

### ■ Specifications

- Manufacture and Sale of Medical Equipment Certification Number : 221AGBZX00290A01
- Rated Voltage : AC100V
- Rating Current : 4.5A
- Rated Frequency : 50/60Hz
- Rated Voltage of Electrolysis : 50V (max.)
- Total Power Consumption : Approximately 260W
- Electrolysis Tank : 4 layered 8 cells
- Electrode : Platinum-coated titanium plate
- Processed Water Inflow System : 2-way system
- Antioxidant Water 4.0 liter per minute (max.)
- Acidic Water 4.0 liter per minute (max.) Purified Water 5.0 liter per minute (max.)※Inflow Pressure : 180 kpa
- Pipe Pressure Range : 50 kpa (Minimum operating pressure) ~ 700 kpa
- Weight (the body) : about 3kg
- Power Cable length : Approximately 2.7m
- Size (the body) : 276 (W) × 248 (H) × 112 (D) mm
- Water Purification Cartridge Filtration Capacity : 13 tons of the 13 substances, specified by JIS (Japanese Industrial Standards) to be removed from tap water. (It is capable of filtering 19 liter per day, for a year. Its capability may vary depending on the inflow volume, pressure, or quality of water.)  
JIS specified 13 substances : Chlorine Residual (Chalk), Turbidity, General Trihalomethane, Chloroform, Bromodichloromethane, Dibromochloromethane, Bromoform, Tetrachlorethylene, Trichlorethylene, 1, 1, 1 - Trichloroethane CAT (Pesticides), 2-MIB (Mold Odor), and Solubility of Lead.
- Electrolytic tank cleaning methods : Double Auto-Change Cross-Line System
- Power Circuit : Switching Regulator Control System
- Malfunctioning Protection features for : Twin Safety Valve (Hot water inflow prevention, high water pressure inflow prevention), Constant current control circuit, and Overheating Prevention Device.
- ※Because of the printed quality of this brochure, the actual products may appear to be in different colors from the pictures herein.
- ※The design and specifications of this product may change for its improvement, without a notice.

Vender



**SANWA Co., Ltd.**

Head Office : 1-6-9 Hakataekiminami, Hakata-ku,  
Fukuoka-shi, Fukuoka, 812-0016 Japan  
TEL : 092-471-5538 FAX : 092-471-5588  
<http://www.sanwa-inf.net/>

Manufacture



**Trim Electric Machinery Co., Ltd.**

Memo (Sales rep information, etc.)